



# Navigation System Owner's Manual

Supplement for  
Apple CarPlay and Android Auto



**TOYOTA MOTOR CORPORATION AUSTRALIA LIMITED**

A.B.N. 64 009 686 097

© 2019 TOYOTA MOTOR CORPORATION AUSTRALIA LIMITED

All rights reserved. This material may not be reproduced or copied, in whole or part, without the written permission of Toyota Motor Corporation Australia Limited, 155 Bertie Street, Port Melbourne, Victoria

<b>Quick guide</b>	<ul style="list-style-type: none"> <li>• Basic system overview</li> <li>• Giving guidance for the route quickly</li> </ul>	<b>1</b>
<b>Basic function</b>	<ul style="list-style-type: none"> <li>• Information to be read before operation</li> <li>• Setting initial settings before operation</li> <li>• Connecting the Bluetooth® device</li> </ul>	<b>2</b>
<b>Navigation system*</b>	<ul style="list-style-type: none"> <li>• Operating the map screen</li> <li>• Searching the map</li> <li>• Activating route guidance</li> </ul>	<b>3</b>
<b>Audio/visual system</b>	<ul style="list-style-type: none"> <li>• Listening to the radio</li> <li>• Enjoying music and video</li> </ul>	<b>4</b>
<b>Speech command system</b>	<ul style="list-style-type: none"> <li>• Operating the speech command system</li> </ul>	<b>5</b>
<b>Peripheral monitoring system*</b>	<ul style="list-style-type: none"> <li>• Checking the situation around the vehicle</li> </ul>	<b>6</b>
<b>Phone</b>	<ul style="list-style-type: none"> <li>• Operating the phone (Hands-free system for cellular phones)</li> </ul>	<b>7</b>
<b>Lexus App Suite</b>	<ul style="list-style-type: none"> <li>• Operating the Lexus App Suite</li> </ul>	<b>8</b>
<b>Software update terms of use</b>		
<b>Index</b>	<ul style="list-style-type: none"> <li>• Search alphabetically</li> </ul>	

\*: For sections shown light shaded, refer to the Navigation System Owner's Manual

### Quick guide

- 1-1. Basic function .....6
  - "Menu" screen .....6
  - "Setup" screen .....7

### Basic function

- 2-1. Basic information before operation .. 10
  - How to use the touchpad/touch screen .....10
  - Linking multi-information display and the system .....10
- 2-2. Connectivity settings ..... 11
  - Registering/Connecting a Bluetooth® device ..... 11
  - Setting Bluetooth® details ..... 11
- 2-3. Apple CarPlay/Android Auto ..... 12
  - Apple CarPlay/Android Auto .....12
- 2-4. Other settings ..... 18
  - General settings .....18

### Audio/visual system

- 4-1. Basic operation .....20
  - Quick reference .....20
  - Some basics.....21
- 4-2. Media operation .....22
  - USB memory .....22
  - iPod/iPhone (Apple CarPlay) .....22
  - Android Auto .....24
  - Bluetooth audio .....26
- 4-3. Audio/visual remote controls .....27
  - Steering switches .....27

### Speech command system

- 5-1. Speech command system operation .30
  - Speech command system .....30
  - Command list .....31

### Phone

- 7-1. Phone operation (Hands-free system for cellular phones) .....34
  - Some basics .....34

### Lexus App Suite

- 8-1. Lexus App Suite overview.....36
  - Lexus App Suite service .....36
- 8-2. Lexus App Suite operation .....38
  - Lexus App Suite.....38
- 8-3. Setup.....42
  - Lexus App Suite settings .....42

### Software update terms of use

- Software update terms of use.....44

### Alphabetical index

- Alphabetical index .....48

## Introduction

This Navigation System Owner's Manual supplement is to be used in conjunction with the Navigation System Owner's Manual supplied with your vehicle. It explains the operation and features that may differ from the manual provided with the vehicle.

Please read this manual carefully to ensure proper use.

The screens shown in this manual may differ from the actual screen of the system depending on your vehicle, the availability of functions, and map data available at the time this manual was produced.

The screens in this manual will also differ if the screen theme settings have been changed. In some situations when changing between screens, it may take longer than normal for the screen to change, the screen may be blank momentarily or noise may be displayed.

Please be aware that the content of this manual may be different from this system in some cases, such as when the system's software is updated.

The company names and product names appearing on this manual are the trademarks and registered trademarks of their respective companies.



“Menu” screen .....6  
“MENU” screen operation.....6  
“Setup” screen .....7

## “Menu” screen

### “Menu” screen operation

Press the “MENU” button on the Remote Touch to display the menu screen.

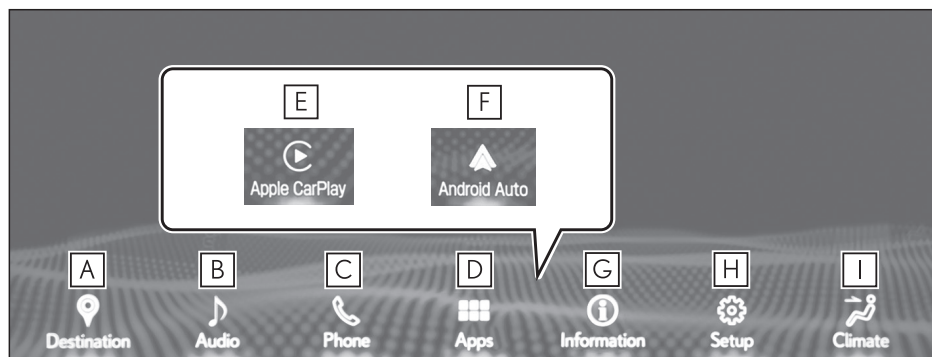

<b>A</b>	Select to display the destination screen. (→Section 3-2 in the Navigation System Owner's Manual)
<b>B</b>	Select to display the audio control screen. (→P.20)
<b>C</b>	Select to display the hands-free control screen. (→Section 7-1 in the Navigation System Owner's Manual) <ul style="list-style-type: none"> <li>When an Apple CarPlay connection is established, select to display the Phone app screen. (→P.12)</li> </ul>
<b>D</b>	Select to display the “Apps” screen. <sup>1</sup> (→P.38)
<b>E</b>	When an Apple CarPlay connection is established and this button is displayed, select to display the home screen of Apple CarPlay. (→P.12)
<b>F</b>	When an Android Auto connection is established and this button is displayed, select to display the home screen of Android Auto. (→P.12)
<b>G</b>	Select to display the energy monitor <sup>2</sup> or fuel consumption screen. <sup>3</sup> <ul style="list-style-type: none"> <li>Move the cursor over the sub menu icon to display the information screen. (→Section 1-1 in the Navigation System Owner's Manual)</li> </ul>
<b>H</b>	Select to display the general settings screen. (→P.18) <ul style="list-style-type: none"> <li>Move the cursor over the sub menu icon to display the “Setup” screen. (→P.7)</li> </ul>
<b>I</b>	Select to display the air conditioning control screen. <sup>3</sup>

<sup>1</sup>: When an Apple CarPlay/Android Auto connection is established, this function will be unavailable.

<sup>2</sup>: Vehicles with hybrid system

<sup>3</sup>: Refer to the “Owner's Manual”.



## “Setup” screen

The “Setup” screen can be reached by the following methods:

1. Press the “MENU” button on the Remote Touch.
2. Select “Setup”.
- Move the cursor over the sub menu icon to display the “Setup” screen.
3. Select the desired item.

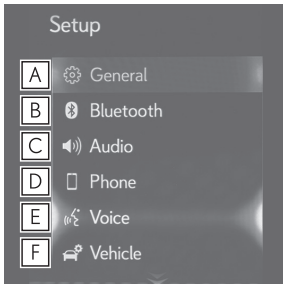

- F** Select to set vehicle information such as vehicle customisation. (→Section 2-4 in the Navigation System Owner’s Manual)
- G** Select to set memory points (home, favourites entries, areas to avoid), or navigation details. (→Section 3-4 in the Navigation System Owner’s Manual)
- H** Select to set Wi-Fi® connection settings. (→Section 2-2 in the Navigation System Owner’s Manual)
- I** Select to set Lexus App Suite settings. (→P.42)
- J** Select to set traffic information.\* (→Section 3-4 in the Navigation System Owner’s Manual)

\*: This function is not made available in some countries or areas.

- A** Select to change the operation sound, etc. (→Section 2-4 in the Navigation System Owner’s Manual)
- B** Select to set Bluetooth® device and Bluetooth® system settings. (→Section 2-2 in the Navigation System Owner’s Manual)
- C** Select to set audio settings. (→Section 4-5 in the Navigation System Owner’s Manual)
- D** Select to set the phone sound, contacts, etc. (→Section 7-2 in the Navigation System Owner’s Manual)
- E** Select to set the voice settings. (→Section 2-4 in the Navigation System Owner’s Manual)



How to use the touchpad/touch screen ..10	
Touchpad gestures .....	10
Touch screen operation .....	10
Linking multi-information display and the system.....	10
Registering/Connecting a Bluetooth® device .....	11
Setting Bluetooth® details .....	11
Apple CarPlay/Android Auto .....	12
Establishing an Apple CarPlay connection ..	12
Establishing an Android Auto connection ...	12
Troubleshooting.....	15
General settings .....	18
Displaying the general settings screen .....	18
Projection settings .....	18

## How to use the touchpad/touch screen

### Touchpad gestures

#### Pinch in/Pinch out

The Apple CarPlay Maps app is not compatible with pinch multi-touch gestures.

### Touch screen operation

#### Pinch in/Pinch out

The Apple CarPlay Maps app is not compatible with pinch multi-touch gestures.

## Linking multi-information display and the system

The following functions of the system are linked with the multi-information display in the instrument cluster:

- Audio
- Phone\*
- etc.

These functions can be operated using the multi-information display control switches on the steering wheel. For details, refer to the "Owner's Manual".

\*: When an Apple CarPlay connection is established, this function will be unavailable.

## Registering/Connecting a Bluetooth® device

To use the hands-free system, it is necessary to register a Bluetooth® phone with the system. Once the phone has been registered, it is possible to use the hands-free system.

This operation cannot be performed while driving.

When an Apple CarPlay connection is established, Bluetooth® functions of the system will become unavailable and any connected Bluetooth® devices will be disconnected.

When connecting to Android Auto, a Bluetooth® connection will be made automatically.

When an Android Auto connection is established, some Bluetooth® functions other than hands-free system cannot be used.

## Setting Bluetooth® details

When an Apple CarPlay connection is established, this function will be unavailable.

When an Android Auto connection is established, some functions will be unavailable.

## Apple CarPlay/Android Auto

Apple CarPlay/Android Auto allows some applications, such as Map, Phone, and Music, to be used on the system.

When an Apple CarPlay/Android Auto connection is established, Apple CarPlay/Android Auto compatible applications will be displayed on the system display.

- **Compatible devices**

Apple iPhone (iOS Ver. 11 or later) that supports Apple CarPlay.

For details, refer to <https://www.apple.com/ios/carplay/> \*

\*: Some devices may not operate with this system.

Android devices with Android OS Ver. 5.0 or higher which support Android Auto and have the Android Auto application installed.

For details, refer to <https://www.android.com/auto/>

### Establishing an Apple CarPlay connection

1. Enable Siri on the device to be connected.
2. Connect the device to the USB port.  
(→Section 4-1 in the Navigation System Owner's Manual)
- Use a high quality USB cable that is less than 1.6 metres in length.
3. Select "Always enable" or "Enable once".
- If "Do not enable" is selected, an Apple CarPlay connection will not be established.

In this case, the device can be operated as a normal Apple device, such as an iPod.

Apple CarPlay will remain off until "Apple CarPlay" of "Projection settings" on the general settings screen is turned on. (→P.18)

- Depending on the device connected, it may take approximately 3 to 6 seconds before the system returns to previous screen.
- The screen may change to step **6** depending on the system.

4. Press the "MENU" button on the Remote Touch.

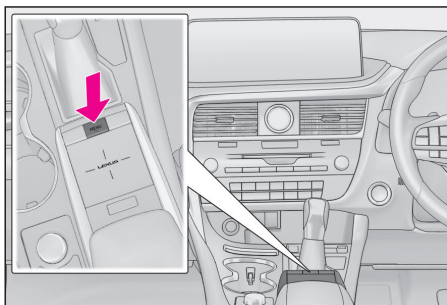

5. Select the "Apple CarPlay".
6. Check the home screen of Apple CarPlay is displayed.

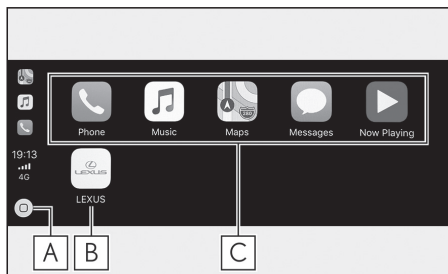

- A** Select to display the home screen of Apple CarPlay. Select and hold to activate Siri.
- B** Select to display the system screen.
- C** Select to start the application. User can use any iPhone application supported by Apple CarPlay.

### Establishing an Android Auto connection

1. Check the Android Auto application is installed to the device to be connected.
2. Connect the device to the USB port.  
(→Section 4-1 in the Navigation System Owner's Manual)
- Use a high quality USB cable that is less than 1.6 metres in length.

**3.** Select “On” to enable the function.

- “Off”: Select to not enable Android Auto.

Android Auto will remain off until “Android Auto” of “Projection settings” on the general settings screen is turned on.

- Depending on the device connected, it may take approximately 3 to 6 seconds before the system returns to previous screen.
- The screen may change to step **6** depending on the system.

**4.** Press the “MENU” button on the Remote Touch.

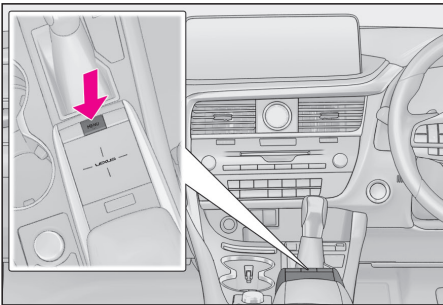

**5.** Select the “Android Auto”.

**6.** Check the home screen of Android Auto is displayed.

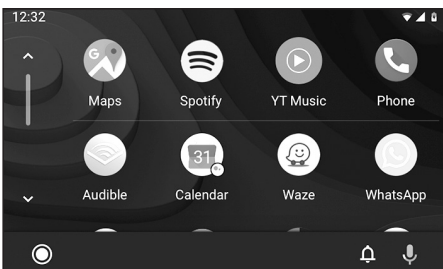

- When an Apple CarPlay/Android Auto connection is established, the function of some system buttons will change.
- When an Apple CarPlay/Android Auto connection is established, some system functions, such as the following, will be replaced by similar Apple CarPlay/Android Auto functions or will become unavailable:

- iPod (Audio Playback)
- USB audio/USB video
- Bluetooth® audio
- Bluetooth® phone (Apple CarPlay only)
- Lexus App Suite
- When an Android Auto connection is established while using Miracast®, Miracast® may become unavailable.
- The guidance volume can be changed on the voice settings screen.
- Apple CarPlay/Android Auto is an application developed by Apple Inc/Google LLC. Its functions and services may be terminated or changed without notice depending on the connected device’s operation system, hardware and software, or due to changes in Apple CarPlay/Android Auto specifications.
- For a list of the apps supported by Apple CarPlay or Android Auto, refer to their respective website.
- While using these functions, vehicle and user information, such as location and vehicle speed, will be shared with the respective application publisher and the cellular service provider.
- By downloading and using each application, you agree to their terms of use.
- Data for these functions is transmitted using the internet and may incur charges. For information about data transmission fees, contact your cellular service provider.
- Depending on the application, certain functions, such as music playback, may be restricted.
- As the applications for each function are provided by a third-party, they may be subject to change or discontinuation without notice. For details, refer to the website of the function.
- If the vehicle’s navigation system is being used for route guidance and a route is set using the Apple CarPlay/Android Auto Maps app, route guidance will be performed through Apple CarPlay/Android Auto.

If the Apple CarPlay/Android Auto Maps app is being used for route guidance and a route is set using the vehicle's navigation system, route guidance will be performed by the vehicle's navigation system.

- If the USB cable is disconnected, operation of Apple CarPlay/Android Auto will end. At this time, sound output will stop and change to the system screen.



- Use of the Apple CarPlay logo means that a vehicle user interface meets Apple performance standards. Apple is not responsible for the operation of this vehicle or its compliance with safety and regulatory standards.
- Please note that the use of this product with iPhone or iPod may affect wireless performance.
- Apple CarPlay is a trademark of Apple Inc.

# android auto

- Android and Android Auto are trademarks of Google LLC.

## WARNING

- Do not connect smartphone or operate the controls while driving.

## NOTICE

- Do not leave your smartphone in the vehicle. In particular, high temperatures inside the vehicle may damage the smartphone.
- Do not push down on or apply unnecessary pressure to the smartphone while it is connected as this may damage the smartphone or its terminal.
- Do not insert foreign objects into the port as this may damage the smartphone or its terminal.



## Troubleshooting

If you are experiencing difficulties with Apple CarPlay/Android Auto, check the following table.

Symptom	Solution
An Apple CarPlay/Android Auto connection cannot be established.	<p>Check if the device supports Apple CarPlay/Android Auto.</p> <p>Check if Apple CarPlay/Android Auto is enabled on the connected device.</p> <p>Check if the Android Auto application is installed to the device to be connected.</p> <p>For details, refer to  <a href="https://www.apple.com/ios/carplay/">https://www.apple.com/ios/carplay/</a>  <a href="https://www.android.com/auto/">https://www.android.com/auto/</a></p>
	<p>Check if "Apple CarPlay"/"Android Auto" of "Projection settings" on the general settings screen is set to on. (→P.18)</p>
	<p>Check if the USB cable being used is securely connected to the device and USB port.</p> <p>Try connecting the smartphone directly to the USB port in the vehicle, without using the hub.</p> <p>For Apple CarPlay: Check if the Lightning cable being used is certified by Apple and check if Siri is enabled.</p>
	<p>After checking all of the above, try to establish an Apple CarPlay/Android Auto connection. (→P.12)</p>
When an Apple CarPlay/Android Auto connection is established and a video is being played, the video is not displayed, but audio is output through the system.	<p>As the system is not designed to play video through Apple CarPlay/Android Auto, this is not a malfunction.</p>
Although an Apple CarPlay/Android Auto connection is established, audio is not output through the system.	<p>The system may be muted or the volume may be low. Increase the system volume.</p>
The Apple CarPlay/Android Auto screen has artefacts and/or audio from Apple CarPlay/Android Auto has noise.	<p>Check if the USB cable being used to connect the device to the system is damaged. To check if the USB cable is damaged internally, connect the device to another system, such as a PC, and check if the device is recognised by the connected system. (The device should begin charging when connected.)</p>
	<p>After checking all of the above, try to establish an Apple CarPlay/Android Auto connection. (→P.12)</p>

Symptom	Solution
The map display of the Apple CarPlay Maps app cannot be enlarged or contracted with pinch multi-touch gestures.	As the Apple CarPlay Maps app is not compatible with pinch multi-touch gestures, this is not a malfunction.
The Apple CarPlay screen is only displayed in the centre of the 12.3-inch display and does not take up the entire screen.	The 12.3-inch display is supported by iOS Ver. 10 and later. Update to the latest iOS version.
The touchpad does not vibrate on the Apple CarPlay screen.	Vibration feedback is supported by iOS Ver. 11 and later. Update to the latest iOS version.
During Apple CarPlay music application (Apple Music, Spotify, etc.) playback, if the iPhone is operated to start and play audio from an application that is not compatible with Apple CarPlay* and the onboard device volume is changed, the audio of the incompatible application stops and the system resumes playback of the original music application.	This operation is performed according to the specification of the onboard device, this is not a malfunction.
After an interruption, audio (such as navigation route guidance) is played from an application that is not compatible with Apple CarPlay while the onboard device is playing audio (FM/AM, CD, etc.), the system does not resume playback of the original audio (FM/AM, CD, etc.).	This operation is performed according to the specification of the onboard device, this is not a malfunction. Manually change the audio source yourself. Or, do not use applications that are not compatible with Apple CarPlay*. Some navigation applications are compatible from iOS 12, update to the latest iOS and application versions.
When using Apple CarPlay, route guidance arrows and turn by turn navigation are not displayed on the multi-information display and system display. When using Android Auto, turn by turn navigation is not displayed on the multi-information display and system display.	This is not a malfunction as display of these items is not possible with this function.

Symptom	Solution
When using Android Auto, hands-free call audio cannot be heard from the vehicle's speakers.	Disconnect the phone from the USB cable and check if hands-free call audio can be heard using the hands-free system.
	Connect the phone to the system using Android Auto, turn up the volume on the system and check if hands-free call audio can be heard. Check if other sounds can be heard from the vehicle's speakers.

\*: Applications not compatible with Apple CarPlay are applications installed on the iPhone that are not displayed on the Apple CarPlay screen application list. (such as visual voicemail)

## General settings

Settings are available for automatic screen change, operation sounds, etc.

### Displaying the general settings screen

1. Press the "MENU" button on the Remote Touch.

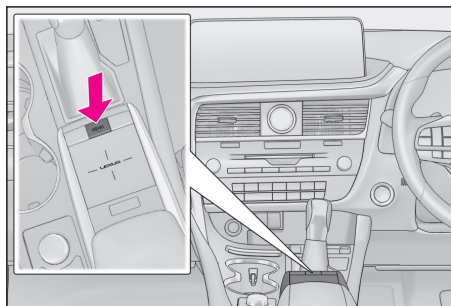

2. Select "Setup".
- If the general settings screen is not displayed, select "General".
3. Select "Projection settings" to set automatic Apple CarPlay/Android Auto connection establishment on/off.

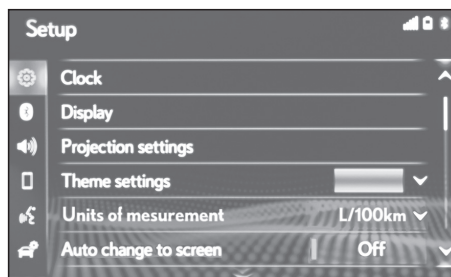

## Projection settings

1. Display the general settings screen.
2. Select "Projection settings".
3. Select the desired items to be set.

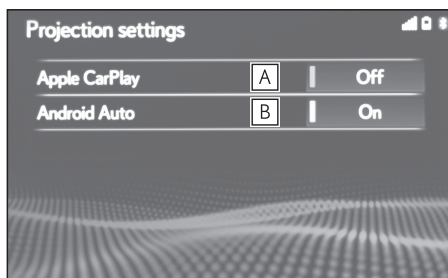

- A** Select to turn Apple CarPlay connection establishment on/off when a compatible iPhone is connected to the system via USB. Depending on the system, this setting cannot be changed when a device is connected to the system via USB. Disconnect the device before attempting to change the setting.
- B** Select to turn Android Auto connection establishment on/off when a compatible device is connected to the system via USB. Depending on the system, this setting cannot be changed when a device is connected to the system via USB. Disconnect the device before attempting to change the setting.

Quick reference .....	20
Functional overview .....	20
Some basics .....	21
Selecting an audio source .....	21
USB/AUX port .....	21
USB memory.....	22
Overview .....	22
iPod/iPhone (Apple CarPlay) .....	22
Overview .....	22
Sub menu .....	24
Android Auto .....	24
Overview .....	24
Sub menu .....	25
Bluetooth audio .....	26
Overview .....	26
Steering switches .....	27
Steering switch operation .....	27

## Quick reference

### Functional overview

The audio control screen can be reached by the following methods:

- ▶ Using the audio control switch.
  1. Press the "RADIO" or "MEDIA" button.
- ▶ Using Remote Touch
  1. Press the "MENU" button on the Remote Touch, then select "Audio".

The audio functions can also be displayed and operated on the side display. (→Section 2-1 in the Navigation System Owner's Manual)

#### ■ Control screen

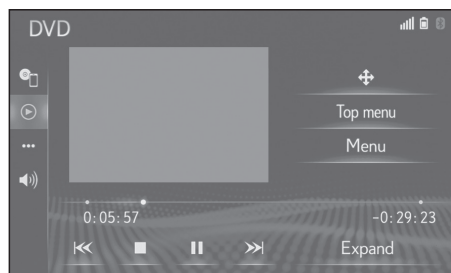

#### ■ Audio control switch

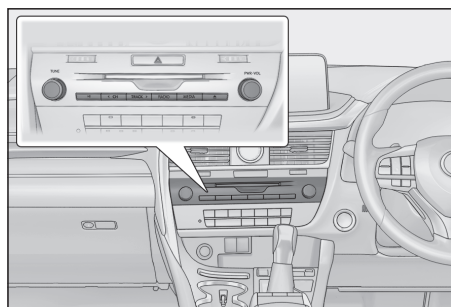

- Using the radio (→Section 4-2 in the Navigation System Owner's Manual)
- Playing an audio CD or MP3/WMA/AAC disc (→Section 4-2 in the Navigation System Owner's Manual)

- Playing a DVD (→Section 4-2 in the Navigation System Owner's Manual)
- Playing a USB memory (→Section 4-3 in the Navigation System Owner's Manual)
- Playing an iPod/iPhone (Apple CarPlay) (→P.22)
- Using the Android Auto (→P.24)
- Playing a Bluetooth® device (→P.26)
- Using the Miracast® (→Section 4-3 in the Navigation System Owner's Manual)
- Using the AUX port (→Section 4-3 in the Navigation System Owner's Manual)
- Using the steering wheel audio switches (→P.27)
- Audio system settings (→Section 4-5 in the Navigation System Owner's Manual)

## Some basics

### Selecting an audio source

▶ Using the audio control switch

1. Press the "RADIO" or "MEDIA" button.

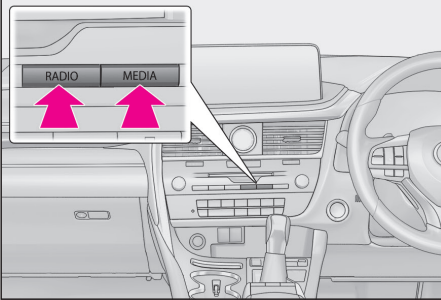

"RADIO" button: Press to change radio modes.

"MEDIA" button: Press to change media modes.

- Each time the "RADIO" or "MEDIA" button is pressed, the audio source changes.
- ▶ From the audio source selection screen
  1. Display the audio control screen.
  2. Select "Source" on the sub menu.
  3. Select the desired source.
- Dimmed screen buttons cannot be operated.
- When there are two pages, select ◀ or ▶ to change the page.
- When an Apple CarPlay/Android Auto connection is established, some system functions, such as the following, will be replaced by similar Apple CarPlay/Android Auto function or will become unavailable:
  - iPod (Audio Playback)
  - USB audio/USB video
  - Bluetooth® audio
  - Lexus App Suite

### USB/AUX port

- When an Apple CarPlay/Android Auto connection is established, the other USB port can only be used as a device battery charger.

## USB memory

### Overview

The USB memory operation screen can be reached by the following methods (→P.21):

- ▶ Using the audio control switch
  1. Press the "MEDIA" button.
- ▶ Using the Remote Touch
  1. Press the "MENU" button on the Remote Touch, then select "Audio".
- Connecting a USB memory. (→Section 4-1 in the Navigation System Owner's Manual)

When an Apple CarPlay/Android Auto connection is established, this function will be unavailable.

## iPod/iPhone (Apple CarPlay)

### Overview

The iPod/iPhone control screen can be reached by the following methods (→P.21):

- ▶ Using the audio control switch
  1. Press the "MEDIA" button.
- ▶ Using the Remote Touch
  1. Press the "MENU" button on the Remote Touch, then select "Audio".
- Connecting an iPod/iPhone. (→Section 4-1 in the Navigation System Owner's Manual)

When an Android Auto connection is established, this function will be unavailable.

### Control screen

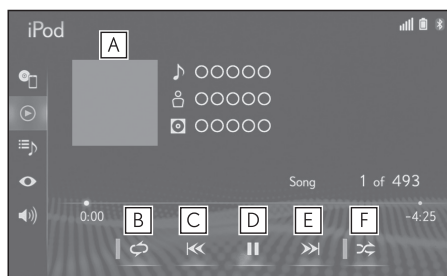

- A** Display cover art.
- B** Select to set repeat playback. (→Section 4-3 in the Navigation System Owner's Manual).
- C** Select to change the track. Select and hold to fast rewind.
- D** Select to play/pause.
- E** Select to change the track. Select and hold to fast forward.
- F** Select to set random playback. (→Section 4-3 in the Navigation System Owner's Manual)



### Repeating

The track currently being listened to can be repeated.

1. Select .

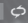
- Each time  is selected, the mode changes as follows:
  - ▶ When shuffle is off (iPhone 5 or later)
    - track repeat → album repeat → off
  - ▶ When shuffle is off (iPhone 4s or earlier)
    - track repeat → off
  - ▶ When shuffle is on
    - track repeat → off

### Random Order

Tracks or albums can be automatically and randomly selected.

1. Select .

- Each time  is selected, the mode changes as follows:
  - shuffle (1 album shuffle) → album shuffle (all album shuffle) → off

### Audio control switch

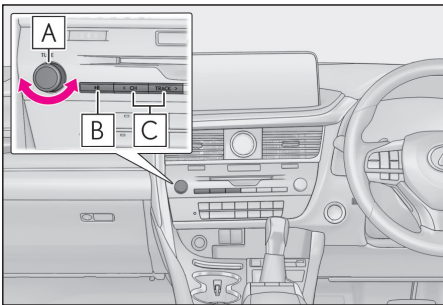

- A** Turn to select a track.
- B** Press to pause/play.
- C** Press to select a track. Press and hold to fast forward/rewind.

When an iPod/iPhone is connected using a genuine iPod/iPhone cable, the iPod/iPhone starts charging its battery.

- Depending on the iPod/iPhone and the songs in the iPod/iPhone, a cover art may be displayed. This function can be changed to “On” or “Off”. (→Section 4-5 in the Navigation System Owner’s Manual)  
It may take time to display the cover art, and the iPod/iPhone may not be operated while the cover art display is in process.
- When an iPod/iPhone is connected and the audio source is changed to iPod/iPhone mode, the iPod/iPhone will resume playing from the same point it was last used.
- Depending on the iPod/iPhone that is connected to the system, certain functions may not be available.
- The system may not function properly if a conversion adapter is used to connect a device.

### WARNING

- Do not connect smartphone or operate the controls while driving.

### NOTICE

- Depending on the size and shape of the iPod/iPhone that is connected to the system, the console box may not close fully. In this case, do not forcibly close the console box as this may damage the iPod/iPhone or the terminal, etc.
- Do not leave your portable player in the vehicle. In particular, high temperatures inside the vehicle may damage the portable player.
- Do not push down on or apply unnecessary pressure to the portable player while it is connected as this may damage the portable player or its terminal.
- Do not insert foreign objects into the port as this may damage the portable player or its terminal.

## Sub menu

- ▶ An Apple CarPlay connection is not established

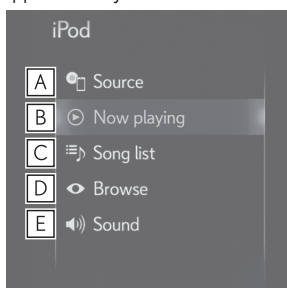

- A** Select to display the audio source selection screen. (→P.21)
- B** Select to return to the control screen.
- C** Select to display a song list screen.
- D** Select to display the play mode selection screen.
- E** Select to display the sound setting screen. (→Section 4-1 in the Navigation System Owner's Manual)
- ▶ An Apple CarPlay connection is established

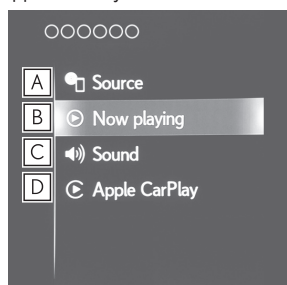

- A** Select to display the audio source selection screen. (→P.21)
- B** Select to return to the control screen.
- C** Select to display the sound setting screen. (→Section 4-1 in the Navigation System Owner's Manual)
- D** Select to display the Apple CarPlay screen.

## Android Auto

### Overview

The Android Auto control screen can be reached by the following methods:

- ▶ Using the audio control switch
  1. Press the "MEDIA" button.
- ▶ Using the Remote Touch
  1. Press the "MENU" button on the Remote Touch, then select "Audio".
  - Connecting an Android device. (→Section 4-1 in the Navigation System Owner's Manual)

When an Apple CarPlay connection is established, this function will be unavailable.

### Control screen

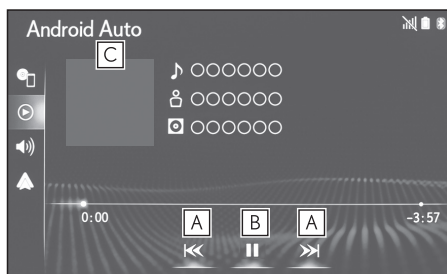

- A** Select to change the track.
- B** Select to play/pause.
- C** Displays cover art.

### Audio control switch

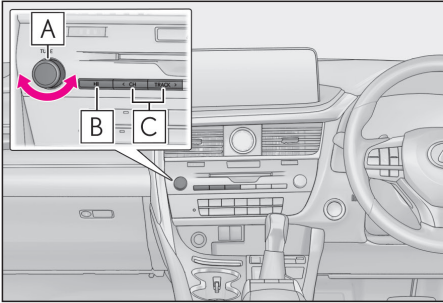

- A** Press to select a track.
- B** Turn to pause/play.
- C** Displays cover art.

### **!** WARNING

- Do not operate the player's controls or connect a smartphone while driving.

### **!** NOTICE

- Depending on the size and shape of the smartphone that is connected to the system, the console box may not close fully. In this case, do not forcibly close the console box as this may damage the smartphone or the terminal, etc.
- Do not leave your smartphone in the vehicle. In particular, high temperatures inside the vehicle may damage the smartphone.
- Do not push down on or apply unnecessary pressure to the smartphone while it is connected as this may damage the smartphone or its terminal.
- Do not insert foreign objects into the port as this may damage the smartphone or its terminal.

### Sub menu



- A** Select to display the audio source selection screen. (→P.21)
- B** Select to return to the control screen.
- C** Select to display the sound setting screen. (→Section 4-1 in the Navigation System Owner's Manual)
- D** Select to display the Android Auto screen.

## Bluetooth audio

The Bluetooth® audio system enables users to enjoy listening to music that is played on a portable player on the vehicle speakers via wireless communication. This audio/visual system supports Bluetooth®, a wireless data system capable of playing portable audio music without cables. If your device does not support Bluetooth®, the Bluetooth® audio system will not function.

### Overview

The Bluetooth® audio control screen can be reached by the following methods:

- ▶ Using the audio control switch
  1. Press the "MEDIA" button.
- ▶ Using the Remote Touch
  1. Press the "MENU" button on the Remote Touch, then select "Audio".
- Connecting a Bluetooth® audio device. (→Section 4-1 in the Navigation System Owner's Manual)
- When an Apple CarPlay/Android Auto connection is established, Bluetooth® audio will be suspended and become unavailable.

### Control screen

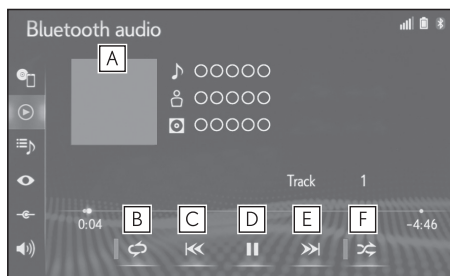

- A** Displays cover art.
- B** Select to set repeat playback. (→Section 4-3 in the Navigation System Owner's Manual)
- C** Select to change the track. Select and hold to fast rewind.
- D** Select to play/pause.

- E** Select to change the track. Select and hold to fast forward.
- F** Select to set random playback. (→Section 4-3 in the Navigation System Owner's Manual)
- Depending on the type of portable player connected, some functions may not be available and/or the screen may look differently than shown in this manual.

## Steering switches

### Steering switch operation

Some parts of the audio/visual system can be adjusted using the switches on the steering wheel.

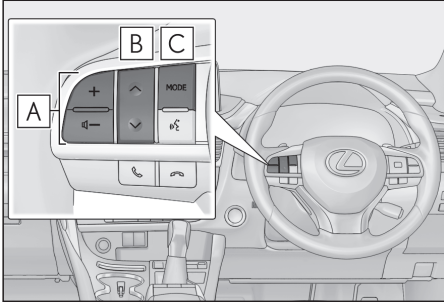

**A** Volume control switch

Mode	Operation/function
All	Press: Volume up/down
	Press and hold (0.8 sec or more): Volume up/down continuously

**B** “^v” switch

Mode	Operation/function
AM/FM	Press: Preset stations up/down (Presets screen)
	Station up/down (Station list screen)
	Seek up/down (Manual tuning screen)
	Press and hold (0.8 sec. or more): Seek up/down continuously while the switch is being pressed (Manual tuning screen)

Mode	Operation/function
DAB	Press: Preset services/stations up/down (Presets screen)
	Service/station up/down (Service/station list screen)
	Seek up/down (Manual tuning screen)
CD	Press and hold (0.8 sec. or more): Seek up/down continuously while the switch is being pressed (Manual tuning screen)
	Press: Track up/down
MP3/WMA/AAC disc	Press and hold (0.8 sec. or more): Fast forward/rewind
	Press: File up/down
DVD	Press and hold (0.8 sec. or more): Fast forward/rewind
	Press: Chapter up/down
USB <sup>1,2</sup>	Press and hold (0.8 sec. or more): Fast forward/rewind
	Press: File/Track up/down
iPod/iPhone <sup>2</sup>	Press and hold (0.8 sec. or more): Fast forward/rewind
	Press: Track up/down
Android Auto <sup>1</sup>	Press: Track up/down
Bluetooth® audio <sup>1,2</sup>	Press and hold (0.8 sec. or more): Fast forward/rewind
	Press: Track up/down

<sup>1</sup>: When an Apple CarPlay connection is established, this function will be unavailable.

<sup>2</sup>: When an Android Auto connection is established, this function will be unavailable.

**C** "MODE" switch

Mode	Operation/function
AM/FM/ DAB, AUX	Press: Change audio modes
	Press and hold (0.8 sec. or more): Mute
CD, MP3/WMA/ AAC disc, DVD, USB <sup>1,2</sup> , iPod/iPhone <sup>2</sup> , Android Auto <sup>1</sup> , Bluetooth <sup>®</sup> audio <sup>1,2</sup> , APPS <sup>1,2</sup>	Press: Change audio modes
	Press and hold (0.8 sec. or more): Pause
Miracast <sup>®</sup>	Press: Change audio modes

<sup>1</sup>: When an Apple CarPlay connection is established, this function will be unavailable.

<sup>2</sup>: When an Android Auto connection is established, this function will be unavailable.

- In the APPS mode, some operations may be done on the screen depending on the selected APPS.

Speech command system .....30  
    Using speech command system .....30

Command list .....31  
    Command list overview .....31  
    Command list .....31

## Speech command system

The speech command system enables the radio, phone dialing, etc. to be operated using speech commands.

Refer to the command list for samples of speech commands. (→P.31)

## Using speech command system

### ■ Talk switch

Press the talk switch to start the speech command system.

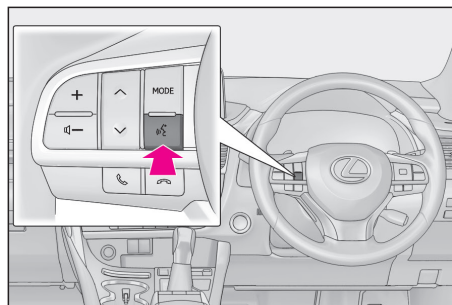

- Speech command system:
  - Press the talk switch to start the speech command system. Press and hold the talk switch to cancel the speech command system.
- When an Apple CarPlay/Android Auto connection is established:
  - Press and hold the talk switch to start Siri/Google Assistant. To cancel Siri/Google Assistant, press the talk switch.
  - Press the talk switch to start the speech command system.

### ■ Microphone

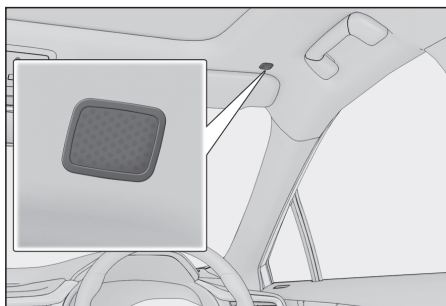

- It is unnecessary to speak directly into the microphone when giving a command.
- Wait for the listening beep before speaking a command.
- Speech commands may not be recognised if:
  - Spoken too quickly.
  - Spoken at a low or high volume.
  - The roof or windows are open.
  - Passengers are talking while speech commands are spoken.
  - The fan speed of the air conditioning system is set at high.
  - The air conditioning vents are turned towards the microphone.
  - The command is incorrect or unclear. Note that certain words, accents or speech patterns may be difficult for the system to recognise.
  - There is excessive background noise, such as wind noise.
- This system may not operate immediately after the engine switch <power switch> is turned to ACCESSORY or IGNITION ON mode <ON mode>.

### NOTICE

Do not touch and put a sharp object to the microphone. It may cause failure.



## Command list

### Command list overview

Recognisable speech commands and their actions are shown below.

- Frequently used commands are listed in the following tables.
- For devices that are not installed to the vehicle, commands relating to that device may not be displayed on the screen. Also, depending on other conditions, such as compatibility, some commands may not be displayed on the screen.
- The functions available may vary according to the system installed.
- When an Apple CarPlay/Android Auto connection is established, some commands will become unavailable.

### Command list

#### ■ Common

Command	Action
"Go back"	Returns to the previous screen
"Help"	Prompts voice guidance to offer examples of commands or operation methods
"Cancel"	Cancels the speech command system
"Start over"	Returns to top menu screen
"Pause"	Temporarily pauses a voice session until it is resumed by pressing the talk switch again

#### ■ Top menu

Command	Action
"Go to <function>"	Displays the command list of the selected function
"More hints"	Displays more commonly used commands

## ■ Audio

Command	Action
"Play artist <artist name>" <sup>*1</sup>	Plays tracks from the selected artist
"Play album <album name>" <sup>*1</sup>	Plays tracks from the selected album
"Play playlist <playlist name>" <sup>*1,2</sup>	Plays tracks from the selected playlist
"Play song <song>" <sup>*1</sup>	Plays the selected track
"Disc"	Selects the selected disc mode
"Auxiliary"	Selects AUX audio mode
"USB"	Selects USB audio mode that is connected first
"USB2"	Selects USB audio mode that is connected last
"iPod"	Selects iPod audio mode that is connected first
"iPod2"	Selects iPod audio mode that is connected last
"Bluetooth audio"	Selects Bluetooth® audio mode
"Android Auto" <sup>*3</sup>	Selects Android Auto music

\*1: The audio device must be connected via a USB cable to use the functionality

\*2: Available only for iPod/iPhone

\*3: Available when an Android Auto connection is established.

Some basics ..... 34  
Using the phone switch / microphone ..... 34

## Some basics

The hands-free system enables calls to be made and received without having to take your hands off the steering wheel.

This system supports Bluetooth<sup>®</sup>. Bluetooth<sup>®</sup> is a wireless data system that enables cellular phones to be used without being connected by a cable or placed in a cradle.

The operating procedure of the phone is explained here.

When an Apple CarPlay connection is established, phone functions will be performed by Apple CarPlay instead of the hands-free system.

## Using the phone switch / microphone

### ■ Steering switch

By pressing the phone switch, a call can be received or ended without taking your hands off the steering wheel.

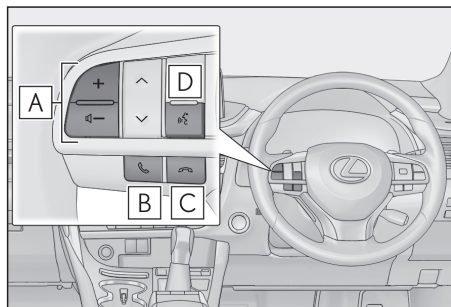

### **A** Volume control switch.

- Press the "+" side to increase the volume.
- Press the "-" side to decrease the volume.

### **B** Off hook switch.

- Press to start talking.
- Press to put a call on hold.
- Depending on the system, if the switch is pressed when an Apple CarPlay connection is established, the Apple CarPlay phone application will be displayed on the system screen.

### **C** On hook switch.

- Press to end talking/dialing.
- Press to refuse to receive the call.

### **D** Talk switch.

- Press the talk switch to start the speech command system. (→P.30)
- To cancel voice recognition, press and hold the talk switch.

Lexus App Suite service .....	36
Lexus App Suite .....	36
Before using the function .....	37
Preparation before using Lexus App Suite ..	37
Lexus App Suite.....	38
Using Lexus App Suite .....	38
Updating an application .....	38
If a message appears on the screen .....	39
Linking Lexus App Suite and navigation local function .....	40
Lexus App Suite settings .....	42
Displaying the Lexus App Suite settings screen.....	42
Lexus App Suite settings screen .....	42

## Lexus App Suite service

Lexus App Suite is a service that enables the usable contents of a smartphone to be displayed on and operated from the navigation screen.

Before Lexus App Suite can be used, a few settings must be performed. (→P.37)

## Lexus App Suite

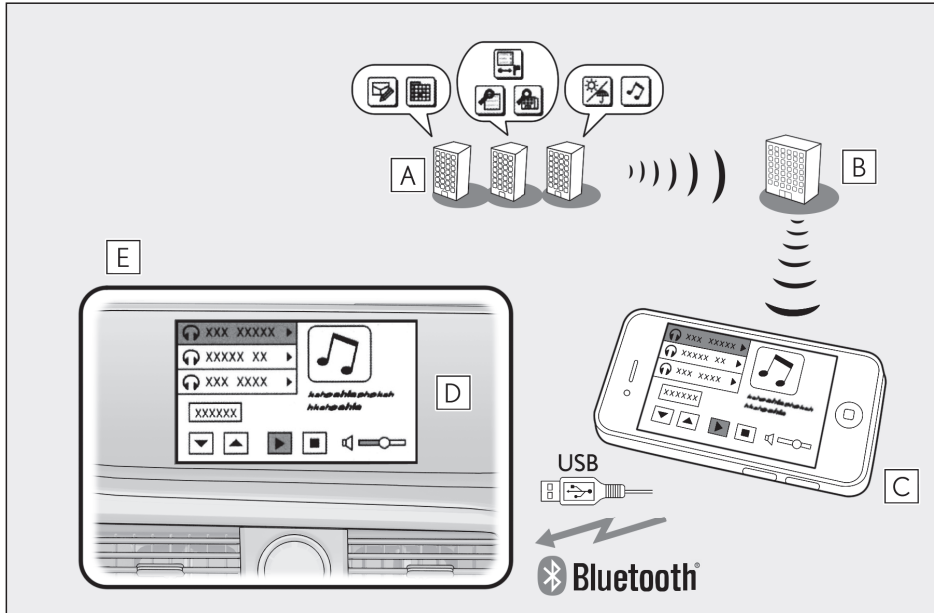

- A** Contents provider.  
Provides contents to the application server.
- B** Application server.  
Provides applications to the navigation system via a smartphone.
- C** Smartphone\*.  
Using the Lexus App Suite application, communication is relayed between the navigation system, the application server and the contents provider.  
A smartphone cannot be operated while communicating.
- D** Applications.  
Displays and sounds the usable contents from the content providers via a smart-phone on the application player.
- E** Navigation system.  
Contents received, via a smartphone, from the contents provider servers are displayed on the navigation screen. The navigation system is equipped with an application player to run applications.

\*: For known compatible phones, refer to <http://www.lexus.com.au/> or <http://www.lexus.co.nz>.

## Before using the function

### ■ Availability of service

- Lexus App Suite is available in Australia and New Zealand.
- When using Lexus App Suite, depending on the details of your smartphone contract, data usage fees may apply. Confirm data usage fees before using this service.
- In this section, the required operations to activate applications, connect a smartphone to the navigation system and registration steps for Lexus App Suite are explained. For details regarding Lexus App Suite operations and each of the applications, refer to <http://www.lexus.com.au/> or <http://www.lexus.co.nz/>.
- The actual service availability is dependent on the network condition.

### ■ Initialising personal data

The personal data used in applications can be reset. (→Section 2-4 in the Navigation System Owner's Manual)

- The following personal data can be deleted and returned to their default settings:
  - Downloaded contents
  - Radio stations that were listened to
  - Entered history
- Once initialised, data will be erased. Pay close attention when initialising the data.

## Preparation before using Lexus App Suite

### ■ Settings required to use Lexus App Suite

Perform the settings in the following order.

1. Download the Lexus App Suite application to your smartphone.
2. Register a Bluetooth® phone with the hands-free system. (→Section 2-2 in the Navigation System Owner's Manual)

- Applications can only be used when the Lexus App Suite application has been downloaded to your smartphone and the application is running.
- Lexus App Suite operational procedures can also be confirmed by visiting <http://www.lexus.com.au/>
- For information on availability of this service in New Zealand, refer to <http://www.lexus.co.nz>

## Lexus App Suite

Lexus App Suite is a service that enables the usable contents of a smartphone to be displayed on and operated from the navigation system screen. Before the Lexus App Suite can be used, some setup needs to be performed. (→P.37)

For details about the function and service provided by each application, refer to <http://www.lexus.com.au/>

- For information on availability of this service in New Zealand, refer to <http://www.lexus.co.nz>

## Using Lexus App Suite

1. Press the "MENU" button on the remote touch.

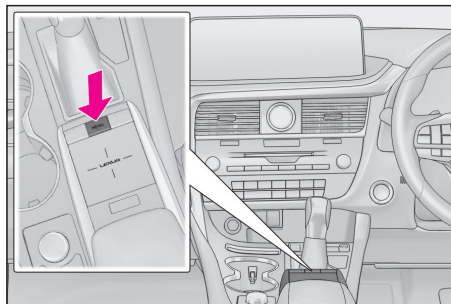

2. Select "Apps".
3. Select the desired application screen button.

**APP1**: Select to activate an application.

"Update": Select to update the application, see below.

**2**: Displays the number of new notifications for the application.

## Updating an application

When the Lexus App Suite is activated, an application may need to be updated. By updating the application, it can be kept to the latest version. To update the application, it is necessary to download the updated data and install it.

### ■ Downloading the updated data

If an update is available, "Update" can be selected.

1. Press the "MENU" button on the remote touch.
2. Select "Apps".
3. Select "Update".

4. Check that downloading starts.

- "Download in background": Select to operate other functions while downloading.
- "Cancel": Select to cancel updating.

5. Check that downloading is complete.

- "Later": Select to install later. When this screen button is selected, the screen will return to the last displayed screen. To install the update data see below.

- "Show details": Select to display detailed information on the update data.

- "Install": Select to install the update data. Follow the steps "Installing the update data" from step 4.

### ■ Installing the updated data

After the downloading is complete, "Update" will be changed to "Install".

1. Press the "MENU" button on the remote touch.
2. Select "Apps".
3. Select "Install".
4. Select "Continue".

- "Later": Select to postpone the installation of the update data and go back to the previous screen.

5. Check that installing is started.

- "Install in background": Select to operate other functions while installing.

6. Select "OK" after the installing is complete.

- The Lexus App Suite function cannot be operated while installing.



### If a message appears on the screen

When problems occur with starting the application player, a message will appear on the screen. Referring to the table below, identify the problem and take the suggested corrective action.

Message	Solution
<ul style="list-style-type: none"> <li>● "When it is safe and legal to do so, ensure your Lexus App Suite phone application is running and logged in."</li> </ul>	<p>The Lexus App Suite application cannot be connected to Bluetooth® SPP.</p> <p>Refer to <a href="http://www.lexus.com.au/">http://www.lexus.com.au/</a> to confirm if the phone is Bluetooth® SPP compatible or not, and then activate the Lexus App Suite application.</p> <ul style="list-style-type: none"> <li>• For information on availability of this service in New Zealand, refer to <a href="http://www.lexus.co.nz">http://www.lexus.co.nz</a></li> </ul>
<ul style="list-style-type: none"> <li>● "Installation failed. Try again."</li> </ul>	<p>Application download can be attempted again by changing to the "Lexus App Suite" screen.</p>
<ul style="list-style-type: none"> <li>● "Download could not be completed. Some Lexus App Suite functions may not work as expected. Reinitiate the download process."</li> <li>● "Application download could not be completed. Try again later."</li> </ul>	<p>The Lexus App Suite application cannot be connected to Bluetooth® SPP.</p> <p>Refer to <a href="http://www.lexus.com.au/">http://www.lexus.com.au/</a> to confirm if the phone is Bluetooth® SPP compatible or not, and then activate the Lexus App Suite application.</p> <p>Please ensure your Lexus App Suite application is running and logged in on your phone while vehicle is not moving.</p> <ul style="list-style-type: none"> <li>• For information on availability of this service in New Zealand, refer to <a href="http://www.lexus.co.nz">http://www.lexus.co.nz</a></li> </ul>

## Linking Lexus App Suite and navigation local function

The navigation system's setting a destination and making a handsfree call can be performed via Lexus App Suite.

For details about the function and service of each application, refer to <http://www.lexus.com.au/>

- For information on availability of this service in New Zealand, refer to <http://www.lexus.co.nz>

### ■ From the map screen

1. Press the "MAP" button on the Remote Touch.

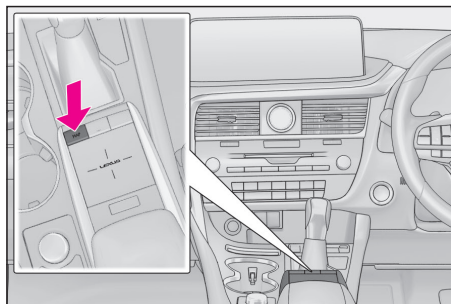

2. Select .
3. Follow the steps in "From the menu screen" from step 3 below.

### ■ From the menu screen

1. Press the "MENU" button on the remote touch.

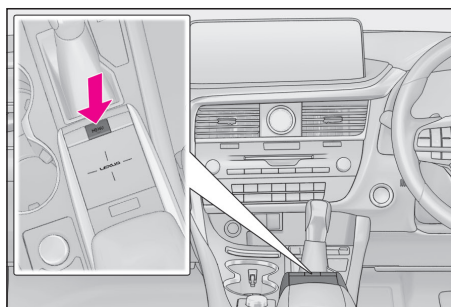

2. Select "Destination".
3. Select "Web search".
4. Check the "Web search" screen is displayed.

## Setting a destination using Lexus App Suite

Locations that were searched using Lexus App Suite can be set as a destination.

### ■ From the map screen

1. Press the "MAP" button on the Remote Touch.
2. Select .
3. Follow the steps in "From the menu screen" from step 3 below.

### ■ From the menu screen

1. Press the "MENU" button on the remote touch.
  2. Select "Destination".
  3. Select "Web search".
  4. Select the desired application button to search.
  5. Enter a search term, and select "Go".
  6. Select "Map".
  7. Select "Go directly".
  8. Select "OK" to start guidance.
- For the operation of the route guidance screen and the function of each screen button. (→Section 3-2 in the Navigation System Owner's Manual)

## Making a phone call using Lexus App Suite

Phone calls can be made to locations which were searched using Lexus App Suite.

### ■ From the map screen

1. Press the "MAP" button on the Remote Touch.
2. Select .
3. Follow the steps in "From the menu screen" from step 3 below.

### ■ From the menu screen

1. Press the "MENU" button on the remote touch.
2. Select "Destination".
3. Select "Web search".
4. Select the desired application button to search.

5. Enter a search term, and select "Go".
  6. Select "Map".
  7. Select a switch for making a call.
  8. Select "Yes".  
"Cancel": Select to cancel making a phone call.
  9. Check that the call screen is displayed.
- For phone operation and the function of each screen button. (→Section 7-1 in the Navigation System Owner's Manual)

### Entering keyword operation

A keyword can be entered to an application by the software keyboard.

For details about the functions and services provided by each application, refer to <http://www.lexus.com.au/>

- For information on availability of this service in New Zealand, refer to <http://www.lexus.co.nz>

#### ■ Entering a keyword using the software keyboard

1. Press the "MENU" button on the remote touch.
  2. Select "Apps".
  3. Select the desired application screen button.
  4. Select the character entering space.
  5. Enter a search terms, and then select "OK".
  6. Entering characters will be reflected on the character entering space.
- For details on operating the keyboard. (→Section 2-1 in the Navigation System Owner's Manual)

## Lexus App Suite settings

Settings are available for Lexus App Suite.

### Displaying the Lexus App Suite settings screen

1. Press the "MENU" button on the remote touch.

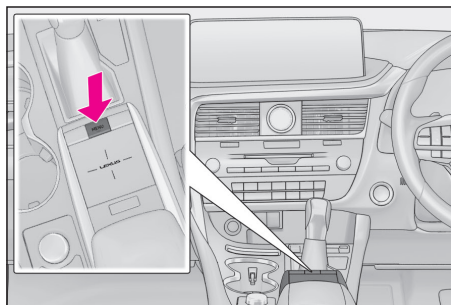

2. Select "Setup".
3. Select "Lexus App Suite".
4. Select the items to be set.

### Lexus App Suite settings screen

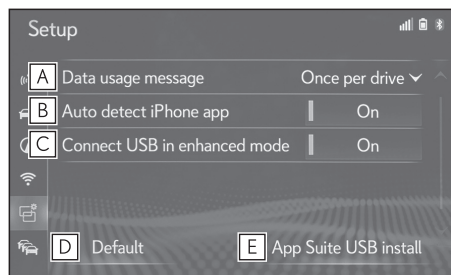

- A** Select to set the pop up reminder for smartphone data usage.
- B** Select to detect iPhone app automatically on/off.
- C** Select to use enhanced mode with connecting USB device on/off.

- When an iPhone is connected while this setting is set to "On", communication with devices connected to other USB ports may not be possible.

Also, depending on the device, charging may not be possible.

- D** Select to reset all setup items.
- E** Select to install the Lexus App Suite via USB. For details, contact your Lexus dealer.
- This function can be used only for first time installation Lexus App Suite.

## Software update terms of use



By proceeding with the update, you agree and acknowledge that:

- (a) Apple CarPlay\* is a feature of iOS provided by Apple Inc., and is subject to Apple's\* terms of use, available at <https://www.apple.com/ios/carplay/>. In providing Apple CarPlay\*, Apple\* may collect your personal information and user and vehicle information, such as location and vehicle speed. Your personal information will be collected and handled in accordance with Apple's\* privacy policy, available at <https://www.apple.com/au/legal/privacy/en-ww/>;
- (b) Android Auto™ ^ is provided by Google LLC, and is subject to Google's^ terms of use, available at <https://www.android.com/auto/>. In providing Android Auto^, Google^ may collect your personal information and user and vehicle information, such as location and vehicle speed. Your personal information will be collected and handled in accordance with Google's^ privacy policy available at <https://policies.google.com/?hl=en&gl=au>;
- (c) the Lexus App Suite, also known as SmartDeviceLink™ is provided by SmartDeviceLink Consortium, Inc., and is subject to SmartDeviceLink's terms of use <https://smartdevicelink.com/licenses/>. In providing SmartDeviceLink, the SmartDeviceLink Consortium Inc may collect your personal information and user and vehicle information, such as location and vehicle speed. Your personal information will be collected and handled in accordance with the SmartDeviceLink Consortium Inc's privacy policy available at <https://smartdevicelink.com/privacy/>;
- (d) third party fees may apply to access and use some of the features available on Apple CarPlay\*, Android Auto^ and SmartDeviceLink (collectively, the Services). For further information, visit <http://www.apple.com/ios/carplay/>, <https://www.android.com/auto/> or <https://smartdevicelink.com/licenses/>;
- (e) access to and use of the Services requires a compatible device, GPS signal and sufficient mobile data and. Mobile usage is at your cost. For information about data transmission fees, contact your mobile phone service provider. For information about devices compatible with Apple Carplay or Android Auto, refer to [www.apple.com/ios/carplay](http://www.apple.com/ios/carplay) or [www.android.com/auto](http://www.android.com/auto);
- (f) in some States or Territories some or all of the functions provided by the Services are not permitted while driving. Please check your local road rules before using these functions. Please drive safely;
- (g) some functions, including iPod\* (Audio Playback), USB audio / USB video, Bluetooth® audio and Bluetooth® phone may not be available. Personal data or other information (Data) stored on your vehicle's head unit may be lost or destroyed. Toyota Motor Corporation Australia Limited t/as Lexus (Lexus Australia) is not responsible for any loss of Data;
- (h) the terms of Lexus Australia's privacy policy from time to time, available at <http://www.lexus.com.au/smallprint/privacy> (Privacy Policy) are incorporated into these terms of use by reference. If you provide or make available any personal information or sensitive information of a third party to Lexus Australia you warrant that you have obtained the third party's consent to disclose their information to Lexus Australia for collection, use and transfer in accordance with the terms of the Privacy Policy;

\*: Apple, iPod and Apple Carplay are trademarks of Apple, Inc. registered in the U.S. and other countries.

^ Google and Android Auto are trademarks of Google LLC.

Bluetooth®, is a registered trademark of Bluetooth SIG, Inc.

- (i) use of the Services is at your sole risk and that the entire risk as to satisfactory quality, performance, accuracy and effort is with you. To the maximum extent permitted by applicable law, the Services are provided on an “as is” and “as available” basis, with all faults and without warranty of any kind and Lexus Australia hereby disclaims all warranties, guarantees and conditions with respect to the Services;
- (j) Lexus Australia does not warrant against interference with your enjoyment of the Services, that the Services will meet your requirements, that the Services will be uninterrupted or error-free, that defects (if any) in the Services will be corrected or that information provided via the Services is accurate, complete, current or suitable to your purposes. No oral or written information or advice given by Lexus Australia or its authorised representative shall create a warranty;
- (k) Lexus Australia, and its licensors, reserve the right to change, suspend, remove, terminate or disable access to any Services at any time without notice. In no event will Lexus Australia be liable for the removal of or disabling of access to any such Services;
- (l) certain Services may display, include or make available content, data, information, applications or materials from third parties (Third Party Materials) or provide links to certain third party web sites. By using the Services, you acknowledge and agree that Lexus Australia is not responsible for examining or evaluating the content, accuracy, completeness, timeliness, validity, copyright compliance, legality, decency, quality or any other aspect of such Third Party Materials or web sites.
- Lexus Australia does not warrant or endorse and does not assume and will not have any liability or responsibility to you or any other person for any third-party Services, Third Party Materials or web sites, or for any other materials, products, or services of third parties;
- (m) Lexus Australia expressly limits its liability for breach of a condition or warranty implied or a consumer guarantee imposed by virtue of any legislation to the following remedies (the choice of which is to be at Lexus Australia’s sole discretion):
- i: in the case of goods, the replacement of the goods or supply of equivalent goods, the repair of the goods, the payment of the costs of replacing the goods or of acquiring equivalent goods or the payment of the costs of having the goods repaired; and
  - ii: in the case of services, the supply of the services again or the payment of the cost of having the services supplied again.
- (n) to the extent permitted by law, in no event shall Lexus Australia be liable for any loss or damage (including direct, incidental, special, indirect or consequential damages, loss of profits, loss of data or business interruption costs) arising out of or related to your use or inability to use the Services, however caused, regardless of the theory of liability (contract, tort, including negligence or otherwise) and even if Lexus Australia has been advised of the possibility of such damages. The foregoing limitations will apply even if the above stated remedy fails of its essential purpose;
- (o) Lexus Australia may assign or transfer its rights and obligations under these terms of use to another organisation, but this will not affect your rights or Lexus Australia’s obligations under these terms of use;

\*: Apple, iPod and Apple Carplay are trademarks of Apple, Inc. registered in the U.S. and other countries.

^ Google and Android Auto are trademarks of Google LLC.

Bluetooth®, is a registered trademark of Bluetooth SIG, Inc.

- (p) these terms of use are governed by the laws of Victoria, Australia. The parties submit to the exclusive jurisdiction of its courts and courts of appeal from them. The parties will not object to the exercise of jurisdiction of those courts on any basis.

If you have any questions, please refer to your owner's manual, contact your dealer, or call us on 1800 023 009.

Last updated on 02 October 2019

\*: Apple, iPod and Apple Carplay are trademarks of Apple, Inc. registered in the U.S. and other countries.

^ Google and Android Auto are trademarks of Google LLC.

Bluetooth® is a registered trademark of Bluetooth SIG, Inc.



Alphabetical index



<b>A</b>	
<b>Android Auto</b> .....	24
Overview .....	24
<b>Apple CarPlay/Android Auto</b> .....	12
Establishing an Android Auto connection .....	12
Establishing an Apple CarPlay connection .....	12
Troubleshooting .....	15
<b>B</b>	
<b>Bluetooth audio</b> .....	26
Overview .....	26
<b>C</b>	
<b>Command list</b> .....	31
Command list overview .....	31
<b>G</b>	
<b>General settings</b> .....	18
Displaying the general settings screen .....	18
Projection settings .....	18
<b>H</b>	
<b>How to use the Touchpad/touch screen</b> .....	10
Touchpad gestures .....	10
Touch screen operation .....	10
<b>I</b>	
<b>iPod/iPhone (Apple CarPlay)</b> .....	22
Overview .....	22
<b>L</b>	
<b>Lexus App Suite service</b> .....	36
Before using the function .....	37
If a message appears on the screen .....	39
Lexus App Suite .....	36
Lexus App Suite settings .....	42
Linking Lexus App Suite and navigation local function .....	40
Preparation before using Lexus App Suite .....	37
Updating an application .....	38
Using Lexus App Suite .....	38
<b>Linking multi-information display and the system</b> .....	10
<b>M</b>	
<b>"Menu" screen</b> .....	6
"Menu" screen operation .....	6
<b>P</b>	
<b>Phone basics</b> .....	34
Using the phone switch / microphone .....	34
<b>Q</b>	
<b>Quick reference</b> .....	20
Functional overview .....	20
<b>R</b>	
<b>Registering/Connecting a Bluetooth® device</b> .....	11
<b>S</b>	
<b>Some basics</b>	
Selecting an audio source .....	21
USB/AUX port .....	21
<b>Speech command system</b> .....	30
Using speech command system .....	30
<b>Steering switches</b> .....	27
Steering switch operation .....	27
<b>U</b>	
<b>USB memory</b> .....	22
Overview .....	22

Part No. TSO1911  
Issue No. 1910-01